

Joe Hagerman, Project Manager
Federation of American Scientists
Design Consultant to the MS Emergency
Management Agency



The MS Alternative Housing Pilot Program (AHPP) is a one-time grant competition authorized by Congress¹ to FL, AL, MS, LA, TX to design and build short to intermediate term disaster relief housing.

¹, Public Law 109-234, Emergency Supplemental Appropriations Act for Defense, the Global War on Terror, and Hurricane Recovery, 2006.

The Primary AHPP Objectives

1. Evaluate non-traditional short- and intermediate-term housing alternatives for potential future use ...
2. Identify, develop and evaluate alternatives to FEMA Disaster Housing ...
3. Consider the feasibility of these options as part of the standard package of housing assistance that could be made available ...
4. Address the needs of a variety of populations - historically underserved populations as well as renters, homeowners, single-family dwelling occupants and multi-family dwelling occupants.

The AHPP encourages...

- Innovation and creativity,
- Alternatives that can be produced, transported, and installed in a timely manner,
- Alternatives that are adaptable to a variety of site conditions,
- Housing solutions that will facilitate sustainable and permanent affordable housing.

The MS Solution Started with a Design Charrette ...

- The state brought together design professionals, industry stakeholders, and community members to establish the original goals and develop the proposal that was submitted to FEMA for funding consideration .
- Two units were envisioned...





The Mississippi Park Model

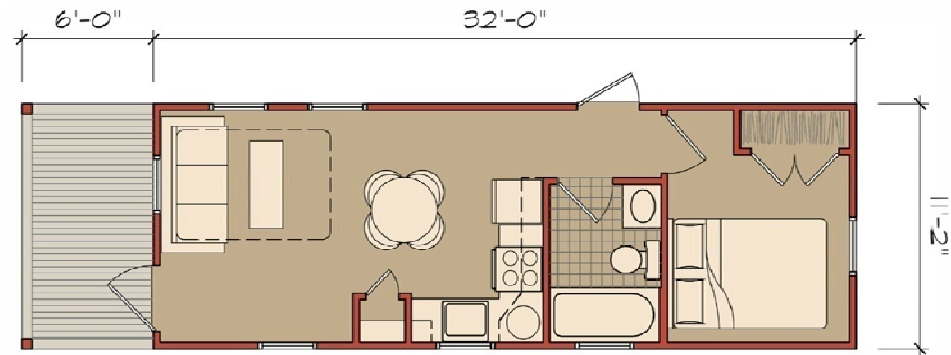

1-bedroom floor plan

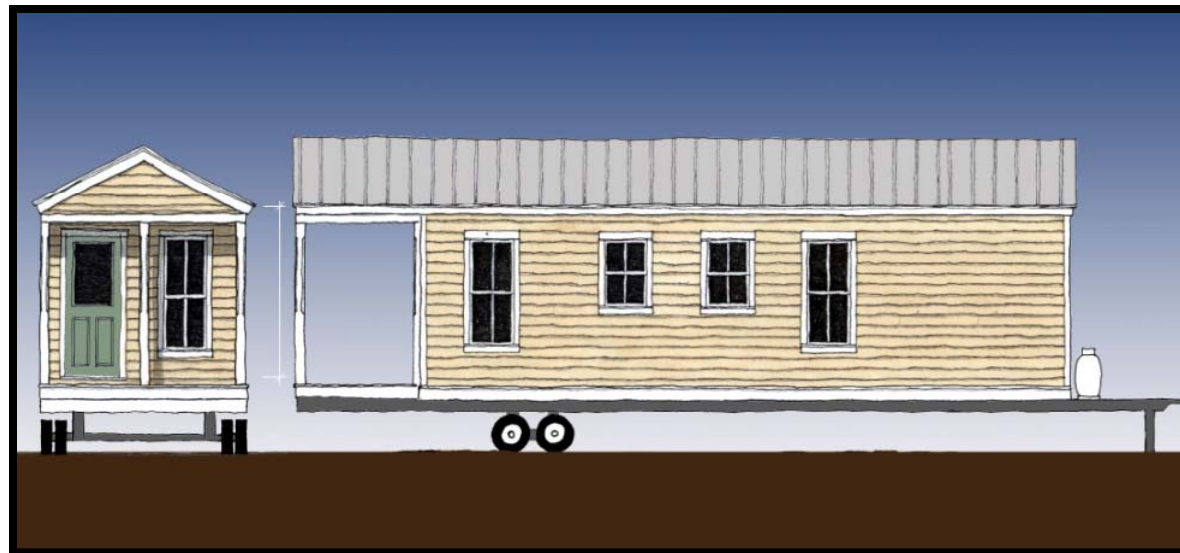

The Mississippi Cottage

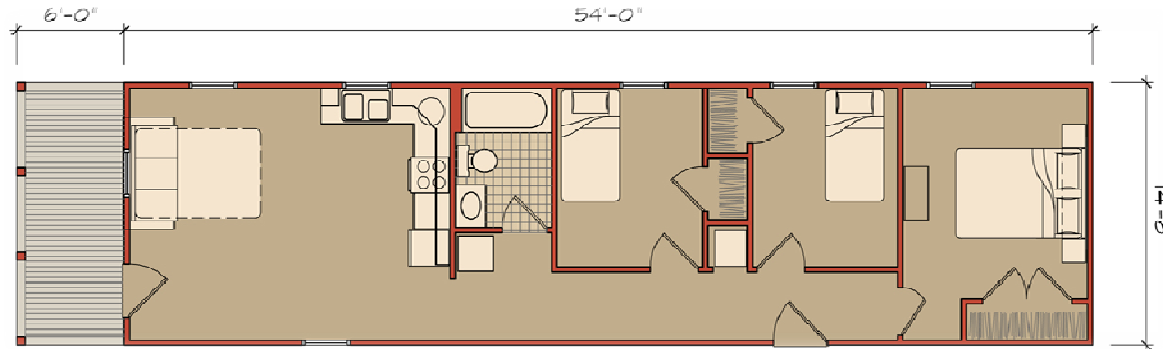

2-bedroom floor plan and 3-bedroom floor plan



The Charrette Resulted in AHPP Design Goals ...

All disaster-relief housing units must ...

- Meet Energy Star[®] requirements for energy efficiency,
- Comply with HUD-code for universal deployment,
- Comply with IRC for local acceptance,
- Exceed local codes to best protect the families affected by Katrina, and
- Be a non-disposable solution and contribute to the permanent affordable housing stock

The State hired architects, engineers, scientists, and other experts to help ...

- design and engineer the unit to the design goals,
BY EXCEEDING THE MINIMUM STANDARDS AND CODES.
- write the comprehensive specification for the units to meet the design goals, and
SPECIFY COMPONENTS AND ASSEMBLIES TO MEET THE DESIGN GOALS.
- run the competitive bid process, oversee the unit's production at each manufacturing facility, and
WORK WITH THE INDUSTRY FOR SUCCESS.

Concept

Design

Bidding

Prototyping

@ plant

Production

@ plant

Receipt

Deployment

A transparent design process
& quality-driven engineering

Cost Comparison of 2-3 Bedroom Emergency Housing Units

	Unit Cost (in \$ thousands)	Annual Operating Costs (\$) ³
FEMA 2006 Average ¹	30-35	1100
Basic MEMA unit ² <ul style="list-style-type: none"> • better than Energy Star[®] • designed for 150mph wind • improved IAQ • improved durability • improved inspections 	32-36	750-800
Basic MEMA unit ² <ul style="list-style-type: none"> • with accessibility upgrade 	37-41	750-800
MEMA unit <ul style="list-style-type: none"> • with accessibility upgrade • with metal roof and other upgrades 	45-55	750-800

1. Mobile Home and Modular Homes at Hope and Red River (Report No. GC-HQ-06-12), Feb 17, 2006
2. Cost estimations determined by the project design team
3. Florida Solar Energy Center(Report No. FSEC-CR-1645-06)

Cost Comparison of 2-3 Bedroom Emergency Housing Units

	Unit Cost (in \$ thousands)	Annual Operating Costs (\$) ³
FEMA 2006 Average ¹	30-35	1100
Basic MEMA unit ² <ul style="list-style-type: none"> • better than Energy Star[®] • designed for 150mph wind • improved IAQ • improved durability • improved inspections 	32-36	750-800
Basic MEMA unit ² <ul style="list-style-type: none"> • with accessibility upgrade 	37-41	750-800
MEMA unit <ul style="list-style-type: none"> • with accessibility upgrade • with metal roof and other upgrades 	45-55	750-800

1. Mobile Home and Modular Homes at Hope and Red River (Report No. GC-HQ-06-12), Feb 17, 2006
2. Cost estimations determined by the project design team
3. Florida Solar Energy Center (Report No. FSEC-CR-1645-06)